

T5 INSERT

T5 INSERT CLASSIC

INSERT

FOR MEDIUM SPACES

Heat Output Cord Wood

72,000 BTU

34,600 BTU EPA Test Fuel

EFFICIENCY (LHV)	80.7%
EMISSIONS	3.4 GM/HR.
LOG SIZE (MAX)	18 IN.
FIRBOX SIZE	2.2 CU.FT.
GLASS SIZE	196 SQ.IN.
WEIGHT	345 LBS.

Transform your fireplace into an efficient heating system with traditional cast iron styling of the T5 Insert, or the beauty and charm of the T5 Classic Insert in lustrous porcelain enamel. Designed to deliver efficient combustion and controlled heat, T5 inserts raise the burn temperature while extending the burn time, providing more heat from less fuel. Like all Pacific Energy inserts they are easy to light, easy to use, and provides a clear view of the flame. With a variable speed fan, clean-glass airwash technology and heavy-gauge overbuilt construction, the T5 Inserts will provide many years of comfort and enjoyment.

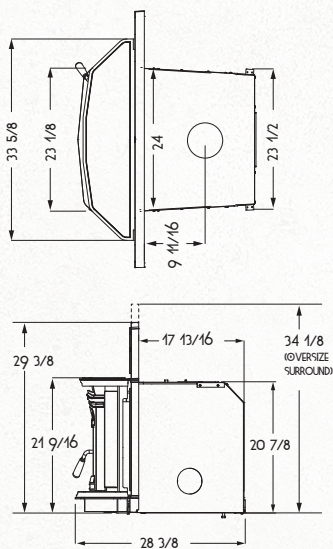

ALDERLEA T5



ALDERLEA T5 CLASSIC

STANDARD FEATURES

Reliable, durable non-catalytic technology
Floating firebox for extended stove life
Airwash Technology for clear, clean glass
Safe, easy straight-in loading
Single-Lever Air Control
304 Stainless Steel Baffle, insulation cover, rails and flame shield
Inside and outside combustion air capable
2x80 cfm temperature-actuated variable-speed blowers
Metallic black cast iron finish (T5 Insert)
North-South loading

DESIGN OPTIONS

T5 Classic Insert: Majolica, Ebony or Ivory
porcelain enamel finish
Surround top: standard or oversize
Standard Surround Top
(42 1/2"W x 30 3/8" H)
Oversized Surround Top
(42 1/2"W x 34 1/8" H)

 **CAST IRON OVER STEEL**

 **AIR WASH**
A SYSTEM BY PACIFIC ENERGY

 **BAFFLE SYSTEM**

 **FLOATING FIREBOX**

 **KNIFE EDGE DOOR**

 **SINGLE LEVER**
AIR CONTROL

